



**J.A. Dawson**  
& Company  
Your Total Recreation Resource

## Springville Elementary Proposed Inclusive Playground







**J.A. Dawson**  
& Company  
Your Total Recreation Resource

## Springville Elementary Proposed Inclusive Playground





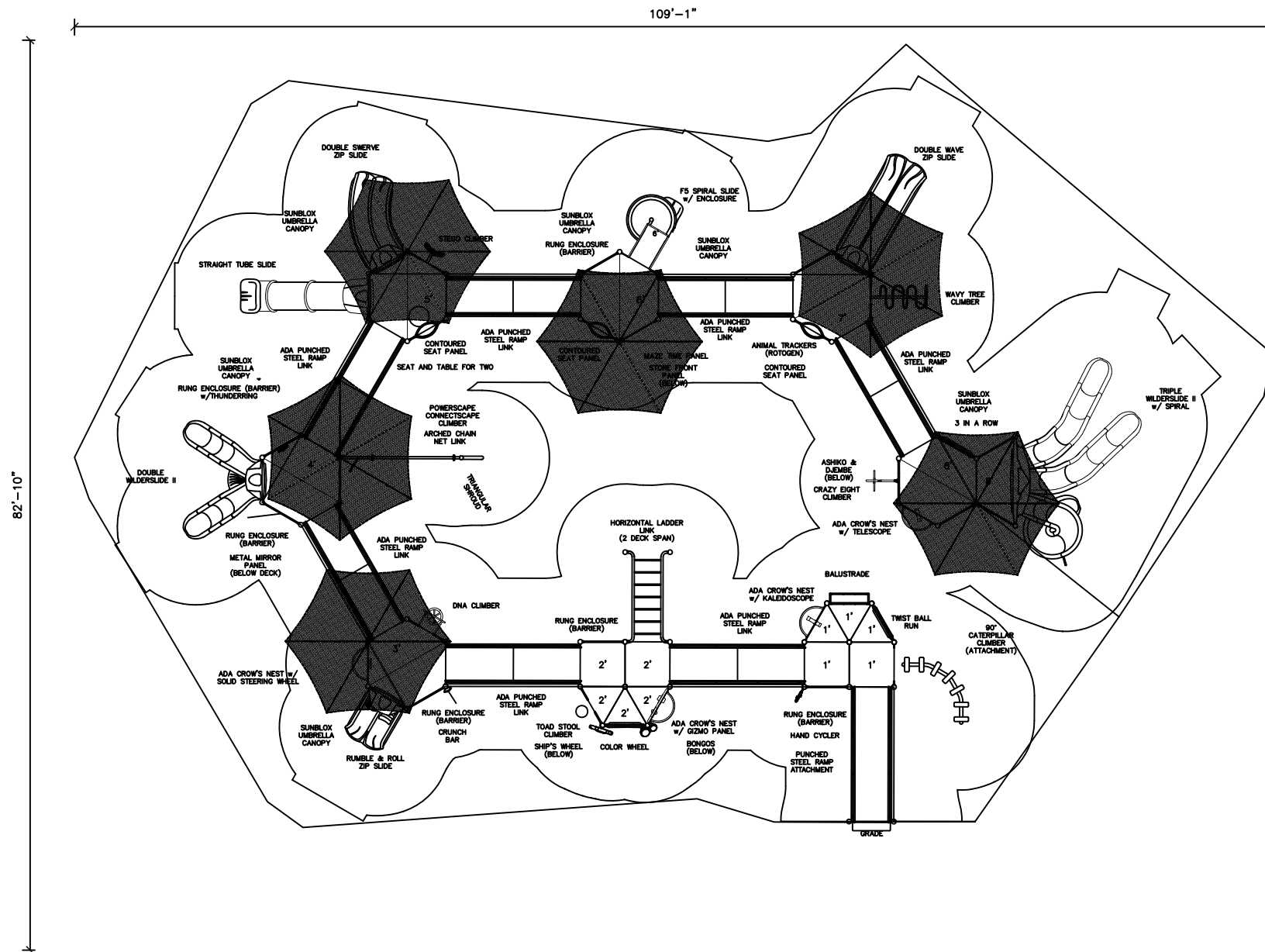

PO Box 1178  
Pelham, AL. 35124  
205.663.5058  
800.221.8869  
f. 205663.5012  
[www.jadawsonco.com](http://www.jadawsonco.com)

Project Manager:  
Kight Jones

Minimum Area Required: 83' x 103'
Scale: NTS
This drawing can be scaled only when in an 8 1/2" x 11" format



c/o J.A. Dawson & Company  
P.O. Box 1178  
Pelham, AL 35124  
Phone: 800-221-8869  
Fax: 205-663-5012

QUOTE  
#65311

04/18/2017

### Springville Elementary Inclusive Playground

Springville Elementary School  
Attn: Lisa Cohron  
75 Wilson Street  
Springville, AL 35146  
Phone: 205-467-6550  
Lisa.cohron@sccboe.org

Ship To Zip: 35146

Quantity	Part #	Description	Unit Price	Amount
1	178749	Game Time - Owner'S Kit	\$50.00	\$50.00
1	RDU	Game Time - 02579 - D2 Custom Inclusive Unit	\$206,325.00	\$206,325.00
120	EWf	Other Manufacturer - Cubic Yards - Engineered Wood Fiber	\$19.00	\$2,280.00
3725	PIP	Other Manufacturer - Square Feet - Poured in Place Safety Surfacing - <i>Includes square footage for turn down into EWF.</i>	\$18.55	\$69,098.75
1	INSTALL	Inlcudes 8" stone base to bring flush to 12" EWF. JA Dawson & Co. - Installation of New Equipment, Surfacing and Border	\$16,400.00	\$16,400.00
			SubTotal:	\$294,153.75
			Discount:	(\$56,409.25)
			Freight:	\$4,947.38
			<b>Total Amount:</b>	<b>\$242,691.88</b>

UNLESS SPECIFICALLY INCLUDED, THIS QUOTATION EXCLUDES ALL EQUIPMENT ASSEMBLY AND INSTALLATION; SAFETY SURFACING; BORDERS AND DRAINAGE PROVISIONS, ALL SITE WORK AND LANDSCAPING; REMOVAL OF EXISTING EQUIPMENT; ACCEPTANCE OF EQUIPMENT AND OFF-LOADING AND STORAGE OF GOODS PRIOR TO INSTALLATION. SIGNED ACCEPTANCE OF THIS QUOTE ASSUMES ACCEPTANCE OF TERMS AND CONDITIONS ON ATTACHED PAGE. TERMS: NET 30 DAYS

## Springville Elementary Inclusive Playground

**QUOTE  
#65311**

04/18/2017

### Acceptance of quotation:

Accepted By (printed): \_\_\_\_\_ Signature: \_\_\_\_\_

P.O. No: \_\_\_\_\_

Purchase Amount: **\$242,691.88**

Date: \_\_\_\_\_

Title: \_\_\_\_\_

Phone: \_\_\_\_\_

Facsimilie: \_\_\_\_\_

### Order Information:

Bill To: \_\_\_\_\_ Contact: \_\_\_\_\_

Address: \_\_\_\_\_ Tel: \_\_\_\_\_

City, State, Zip: \_\_\_\_\_

Ship To: \_\_\_\_\_ Contact: \_\_\_\_\_

Address: \_\_\_\_\_ Tel: \_\_\_\_\_

City, State, Zip: \_\_\_\_\_

FIN# (FEDERAL IDENTIFICATION NUMBER) \_\_\_\_\_

SALES TAX EXEMPTION CERTIFICATE #: \_\_\_\_\_

**COPY OF TAX EXEMPTION CERTIFICATE MUST BE PROVIDED FOR ALL TAX EXEMPT ORDERS**

## Springville Elementary Inclusive Playground

**QUOTE  
#65311**

04/18/2017

**TERMS AND CONDITIONS OF SALE** Required for Complete Order: Purchase Order or signed quote, 50% down and 50% net 30 after delivery or installation with credit approval or 100% payment with order, complete billing & shipping address w/ contact names and phone numbers, and color selections. Contractors provide fully executed bid/performance/payments bonds as applicable. Pricing: f.o.b. factory, firm for 30 days from date of quotation. Acceptance of this Transaction: constitutes entire agreement between buyer and seller. Failure to pay when agreed is basis for legal action to be taken. Buyer agrees to pay all legal costs for collection and reasonable attorney fees, and hereby waives rights of exemption as to personal property under the laws of the state of Alabama or any other state. In connection with this transaction, a finance charge will be imposed on the past due balance at an annual percentage rate of 18%, or 1-1/2% per month. Delivery Schedule: Upon written notification of order (with or without installation services) delivery will be made in appx. 45-60 days. Customer has 10 days after ordering to make request to delay ship date if site will not be ready. All efforts will be made to accommodate requests, but no change is guaranteed. Freight carrier is instructed to call 24 hours in advance to arrange delivery. Returned Goods: Returned goods are subject for a restocking fee of 30% in addition to both the outbound and inbound freight charges. Goods must be packaged to protect against damage in transit in accordance with best commercial practices. Labor and material costs to make returned goods merchantable will be deducted from any credit. Returned goods will not be accepted without an authorization number (RGA) assigned by J.A. Dawson & Co., Inc. To be eligible for credit, returned good must be received at manufacturer within 45 days of issuance of a returned goods authorization number. Unloading: Unless unloading service is contracted, unloading of delivery truck is responsibility of customer. Forklift may be required. If unloading, customer is responsible for accepting and noting any damages or shortages on the freight bill and inspecting/inventorying equipment upon receipt. Customer must notify our office immediately of any discrepancies. Freight carrier is instructed to call your designated contact 24 hours in advance to arrange delivery. If job site is not prepared and ready for installation when equipment delivers, any pre-existing unloading agreement is voided and customer is responsible for truck unloading and equipment storage. Additionally Insured: Any entity or person named as additionally insured, add \$150.00 per each occurrence. **TERMS AND CONDITIONS IF CONTRACTING INSTALLATION SERVICES** Utilities: Customer is responsible for the location and marking of all underground utilities and sprinklers prior to installation. J.A. Dawson & Co., Inc. is not responsible for damages or repairs to any form of underground utility or sprinklers. Equipment Layout: To be as illustrated & accepted on submitted drawings. Any requested changes may result in additional charges. Site Conditions: Installation quotations are based on a prepared level surface (slope not to exceed 1/2" over 25'), and open truck access to the area. We require a 10' wide path into the site and unloaded equipment to be within 100'. Please notify estimator of site concerns to ensure proper quotation. If installation crew arrives and installation cannot be performed due to unprepared surface or inadequate access, an additional \$1,500.00 will be charged for return trip. Pier spoils from installation shall be spread at site. Site will be left rough grade. Upcharge of \$65.00 per hour per man plus necessary equipment rental will be added for installation in rock, concrete or existing asphalt. Removal of existing equipment, trees, etc. by others unless specifically contracted. Machinery Use: Installation requires the use of heavy machinery. All efforts are made to minimize damage to the site. It is recommended that all final landscaping, fencing, sidewalks, etc. be completed after installation of equipment and/or surfacing. J.A. Dawson & Co., Inc. is not responsible for damage to grass or other site features due to normal, necessary equipment use. Please notify estimator to discuss concerns prior to accepting quotation in case revisions are needed. Waste Disposal: Dumpster or approved dumping area must be provided for packaging and other waste during installation. J.A. Dawson & Co., Inc. is not responsible for removing waste from the property unless specifically contracted. Security: J.A. Dawson & Co., Inc. is pleased to supply & install your equipment in a timely, professional manner. Upon completion, the equipment is secured with tape to discourage play and allow concrete to dry for 72 hours. Premature play will cause equipment to become loose in the concrete footings. Customer is responsible for prohibiting access to equipment during this critical drying time. J.A. Dawson & Co., Inc. is not responsible for equipment that becomes loose in the concrete due to premature access or events beyond our control. If purchasing rubber safety surfacing, the 72 hour waiting period also applies. Premature access will leave imprints in rubber surfacing. Customer is responsible for security.

\_\_\_\_\_  
J.A. DAWSON & CO., INC.

\_\_\_\_\_  
DATE

\_\_\_\_\_  
CUSTOMER

\_\_\_\_\_  
DATE

### COLOR SELECTION

**Plastic:** \_\_\_\_\_ **Upright:** \_\_\_\_\_  
**Metal:** \_\_\_\_\_ **Deck:** \_\_\_\_\_  
**Rock:** \_\_\_\_\_ **Fabric:** \_\_\_\_\_

Quote prepared by: Stacy Perry